



building communities together

2025 Business Plan Lexington Water (1891)

*Kelly McDonald
Manager of Utilities*

Working in partnership with communities large and small to offer local, sub-regional, and regional services to ensure that the Cariboo Chilcotin is a socially, economically, and environmentally desirable region.

Department Services

- The Cariboo Regional District (CRD) owns and operates the Lexington Community Water System.

Background Information

- The Cariboo Regional District acquired the Lexington Water System effective January 1, 2019.
- The system was comprised of a lake intake, a pumphouse, associated pumps, reservoir, and distribution piping that services 28 parcels.
- The system meets domestic needs only and does not provide water for community fire protection.

Operations

Operational costs will be collected by way of a user fee set at \$980 per year. Taxation will be collected by way of an annual parcel tax of up to \$420 that began in 2019. The Lexington Water Service Establishment Bylaw 5084 and Lexington Water Loan Authorization Bylaw No. 5085 provide function authority.

As Electoral Area F is the only stakeholder, and the *Local Government Act* requires more than one vote, the entire Board is responsible for the governance of this service.

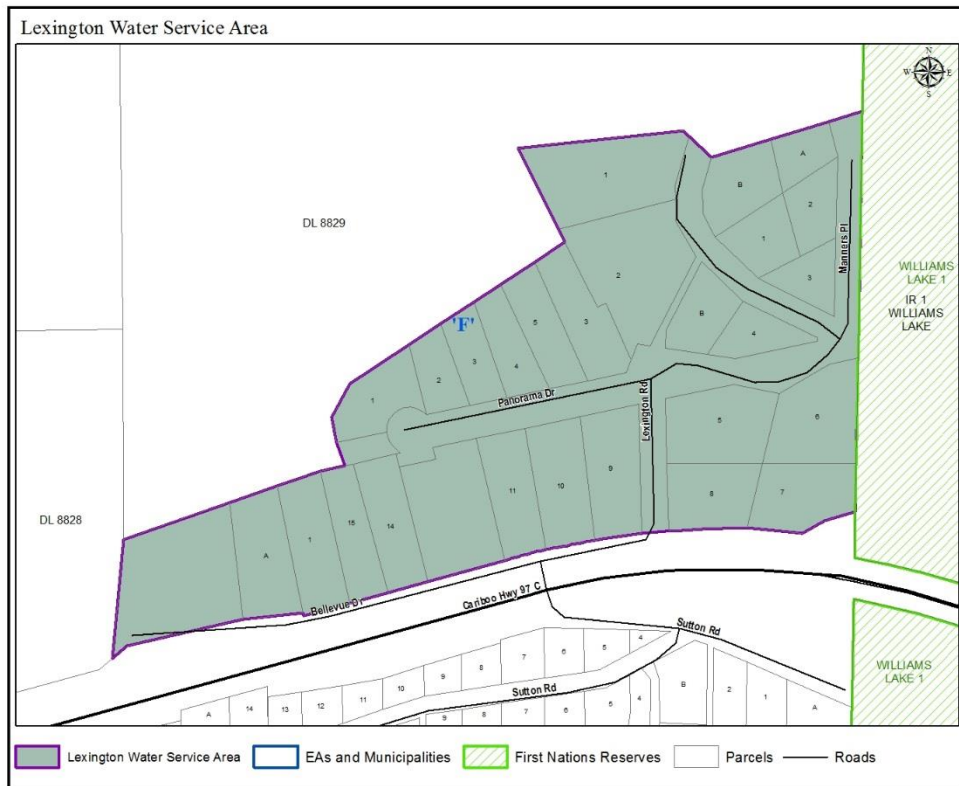

Significant Issues & Trends

The Public Sector Accounting Board requires local governments to report and record tangible capital assets. At some time in the future, local governments may be required to amortize these assets over their useful life.

The Cariboo Regional District is a signatory to the Clean BC Climate Action Plan (formerly the Province of BC/UBCM Climate Action Charter) and has committed to continuing work towards carbon neutrality in respect of corporate operations.

Business Plan Goals, Objectives & Strategies

- Goal:** Extend life of pumps, motors and distribution piping.

Rationale: The Lexington Reservoir is too small for the system. This causes frequent start-stops of the well pump during high demand. Not only will this shorten the lifespan of the pump, but it will also cause water hammer in the system which, over time, increases the likelihood of main breaks and pipe damage.

Strategy: Commission engineered drawings or design built RFP for a secondary or expanded reservoir. Have a project shovel ready for grant applications.

2. **Goal:** Improve water quality and monitoring program.
Rationale: Water quality improvement, more accurate sampling of the distribution system, industry best practice.
Strategy: Add two flushing ports at water main dead ends and one sampling station at a strategic location.

Overall Financial Impact

The projected capital reserve as of December 2024 is \$27,387.

Taxation is collected by way of a parcel tax of \$420.

The current residential user fee is \$980 per year.